

| Energy Efficiency Rating | | |
|---|-------------------------|-----------|
| | Current | Potential |
| Very energy efficient - lower running costs | | |
| (92 plus) A | | |
| (81-91) B | | |
| (69-80) C | 76 | 77 |
| (55-68) D | | |
| (39-54) E | | |
| (21-38) F | | |
| (1-20) G | | |
| Not energy efficient - higher running costs | | |
| England & Wales | EU Directive 2002/91/EC | |

Minsmere Road, Keynsham, Bristol, BS31

Approximate Area = 649 sq ft / 60.3 sq m
Storage = 5 sq ft / 0.5 sq m
Total = 654 sq ft / 60.8 sq m
For identification only - Not to scale



FIRST FLOOR

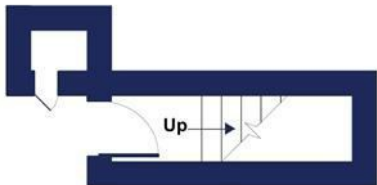

GROUND FLOOR

Floor plan produced in accordance with RICS Property Measurement 2nd Edition, incorporating International Property Measurement Standards (IPMS2 Residential). © nichecom 2025. Produced for Davies & Way. REF: 1283769



DAVIES & WAY

CHARTERED SURVEYORS • ESTATE AGENTS

1 High Street, Keynsham, Bristol, BS31 1DP
Tel: 0117 9863681 email: keynsham@daviesandway.com

8 Minsmere Road, Keynsham, Bristol, BS31 1PN



£230,000

A bright and airy two double bedroom first floor flat that's offered to the market with no onward chain

- First Floor Flat
- Private entrance
- Hallway
- Lounge
- Kitchen
- Two double bedrooms
- Bathroom
- Garage in a block
- Marketed with no onward chain

www.daviesandway.com
CONSUMER PROTECTION FROM UNFAIR TRADING REGULATIONS 2008
These details are for guidance only and complete accuracy cannot be guaranteed. If there is any point which is of particular importance verification should be obtained. They do not constitute a contract or part of a contract. References to tenure of a property are based on information supplied by the seller. The agent has not had sight of the title documents. A buyer is advised to obtain verification from their conveyancer. All measurements are approximate and floor plans are for guidance only. No guarantee can be given with regard to planning permissions or fitness for purpose. No apparatus, equipment, fixture or fitting has been tested. Photographs may have been taken using a wide angled lens and items shown in photographs are NOT necessarily included. Interested parties are advised to check availability and make an appointment to view before travelling to see a property. The property is offered subject to being unsold.
DATA PROTECTION ACT 1998: Please note that all personal information by customers wishing to receive information and/or services from Davies and Way will be processed by the agent and may be shared with third parties. If you do not wish your personal information to be used for any of these purposes, please notify us.



8 Minsmere Road, Keynsham, Bristol, BS31 1PN

This spacious two double bedroom first floor Apartment that's offered to the market with no onward chain, making it an ideal purchase for both first time buyers or those looking for investment purposes.

Internally the accommodation is predominately arranged over the first floor, however the property boasts a private entrance on the ground floor with stairs rising to the first floor and the remaining accommodation which consists of a generous lounge, a kitchen, two double bedrooms and a three piece suite bathroom.

The property further benefits from a garage located in a block and no onward sales chain.

INTERIOR

GROUND FLOOR

ENTRANCE HALLWAY 1.1m x 0.9m (3'7" x 2'11")
Power points, stairs rising to first floor landing.

FIRST FLOOR

LANDING 2.1m x 0.9m (6'10" x 2'11")
Access to loft via hatch, built in storage cupboard housing gas combination boiler, power point, doors leading to rooms.

LOUNGE 5m x 3.3m (16'4" x 10'9")
Double glazed window to front aspect, feature electric fireplace with solid wood mantle, radiator, power points, opening leading to kitchen.

KITCHEN 2.8m x 2.5m (9'2" x 8'2")
Double glazed window to rear aspect. Kitchen comprising range of matching wall and base units with roll top work surfaces, bowl and a quarter sink with mixer tap over, integrated electric oven, four ring electric hob with extractor fan over and integrated microwave. Space and plumbing for washing machine, space for upright fridge/freezer, power points, tiled splashbacks to all wet areas.

BEDROOM ONE 4.9m x 2.9m (16'0" x 9'6")
Double glazed window to front aspect, built in wardrobe, radiator, power points.

BEDROOM TWO 2.9m x 2.9m (9'6" x 9'6")
Double glazed window to rear aspect, radiator, power points.

BATHROOM 1.9m x 1.7m (6'2" x 5'6")
Obscured double glazed window to rear aspect, matching three piece suite comprising pedestal wash hand basin, low level WC and panelled bath with shower off mains supply over, heated towel rail, tiled splashbacks to all wet areas

EXTERIOR

GARAGE
Single garage located nearby within a block.

TENURE
This property is leasehold with approximately 120 years remaining. An annual ground rent of approximately £150 is payable.

COUNCIL TAX
Prospective purchasers are to be aware that this property is in council tax band B according to www.gov.uk website.

ADDITIONAL INFORMATION
Local authority: Bath and North East somerset.
Services: All services connected.
Broadband speed: Ultrafast 1000mbps (Source - Ofcom).
Mobile phone signal: outside EE O2, Three, Vodafone - all likely available (Source - Ofcom)
The photos used for marketing were taken in 2025.

